

Installation Instructions

Assembly

Materials Needed

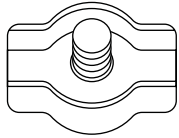

Cable screw thread

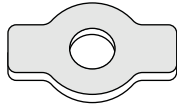

Cable plate



Cable locking nut

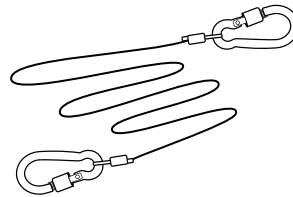

Safety cable

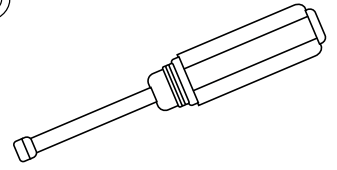

10mm Socket driver
(Not included)

Instructions

1. Pass end of safety cable through the clip on one side of the screw thread. Create a loop in the safety cable and pass back through the clip on the opposite side of the screw thread.

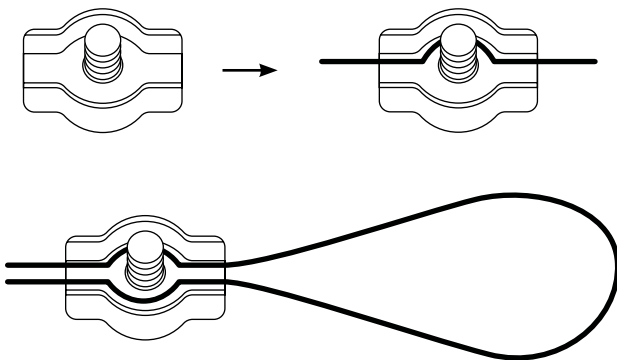

2. **IMPORTANT:** Make sure there is **NO** slack in the safety cable.

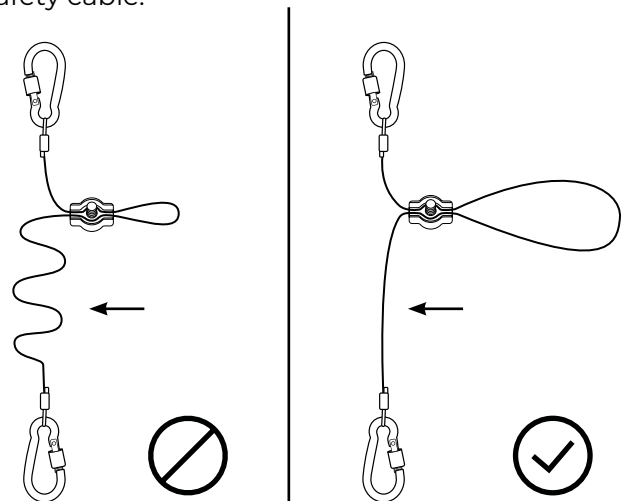

3. Place the plate over the screw thread to hold the safety cable securely.

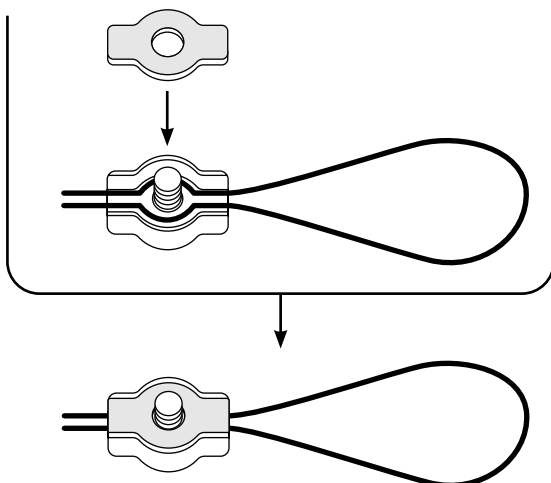

4. Place the locking nut over the screw. Use a 10mm socket to tighten the locking nut. Finished!

